

Tree Machine by, Choi Jaehyeog and Won Jongho, (South Korea)



Scenario

In 2020' the world faced Oil peak much faster than we had expected in 2010'. As a result a large number of countries, including South Korea, go through severe economic recession. We presume that the site is located in old Residential area in Gangnam district, Seoul, South Korea in 2030. The site is dominated by apartments built in 1980. Now, 2030, this residential district is supposed to be re-developed because of safety problem of old high-rise buildings. Site will be developed as a public park because there is no company that wants to get into building construction business in the age of economic recession. New park that will be built in the site should devote to both urban economy and environment.

Manifesto

We need to suggest 21c Landmark Pak that is more functional and sustainable than other parks which are usually used as space for amenity and community. We believe that park could be an infrastructure that plays a significant role in supporting urban system. 21c Park should be more functional both in social and in economic, closely interacting with adjacent urban fabric.

5

YEAR 2030 SCENARIO 01 EMERGENCE OF MULTI FUNCTIONAL PARK

World Wide Crisis

In 2030, the world is facing the most dangerous moment, Oil that has supported the global economy has depleted since 2020. It means that almost every economic activity has to be stopped.

As a result of the oil depletion, global economy is facing horrible season. For example, the stock price has been collapsed all over the world, resulting in paralysis of global liquidity.

Like other countries of the world, Korea encountered economic recession, because of the structure of Korean economy that has been based on the oil industry, almost all economic activities has been threatened.



Apartment Story

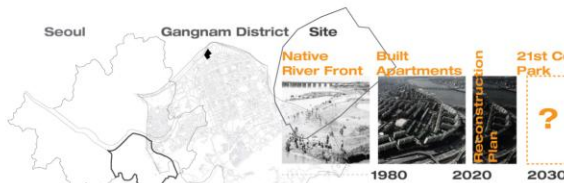

Gangnam district, which is located in the southern part of Seoul, has been a symbol of the success of Korean economy, especially apartment complexes.

Originally, the site itself used to a normal riverfront. In 1980, apartments were built on the site, had been maintained one of the most expensive and successful residential fabric.

In 2020, those apartments were allowed to reconstruct because of deterioration.

However, because of the sudden economic recession, reconstruction capital has gone and the plan was cancelled. So instead of reconstruction, we have to find another way to infill one of the most valuable land, and it will be a park. This park has to be different from previous parks in terms of function and operation.

What is the 21c functional park that contributes to urban economy and global environment?

How much have we spent on producing and maintaining green fabric in Seoul ?

Green Fabric of Gangnam District, Seoul

There are 55 numbers of public parks in Gangnam district.

Total amount of area is 4,291,129 m².

Construction/Maintenance cost

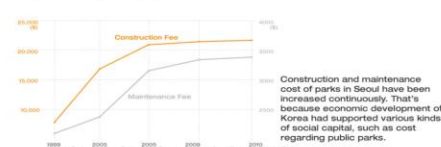

Economic Inefficiency / Sustainable Strategy to keep Existing Green Fabric

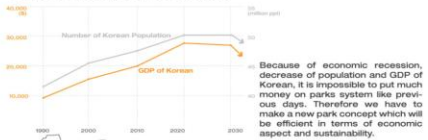

Main Concept

Suburban Seedling Fields for Green Fabrics in Gangnam District

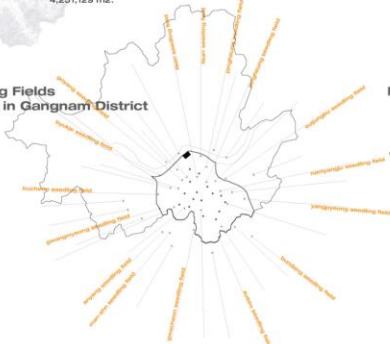

Park as a Local Seedling Core



We propose making urban seedling core on the site.

Public parks and private gardens in apartment complexes in Gangnam district has been maintained by many tree sources from suburban seedling fields, during the delivery of seedlings through roads, it causes transportation fees, carbon dioxide emission more than needed.

Urban seedling field that we propose can cover the maintenance needs of parks and gardens in Gangnam district, reducing maintenance fees, carbon dioxide emission.

OPERATION FOR GREEN PRODUCTION 02
MAKING URBAN SEEDLING CORE

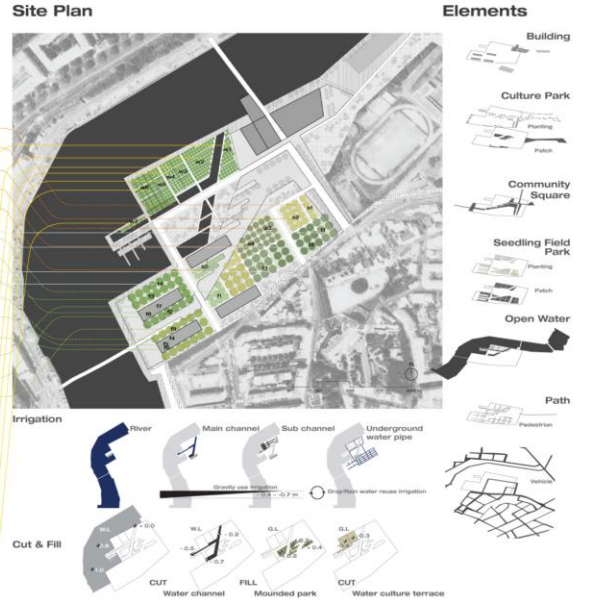
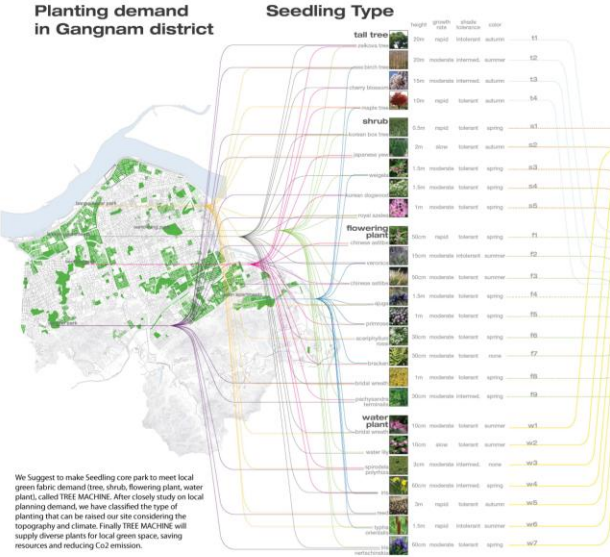
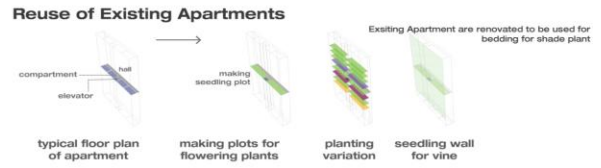

OPERATION FOR CULTURAL PARK 03
MAKING URBAN CULTURAL CORE

